



11
MINUTES

THE TOWER SPACE 2000

The KBL Tower space 2000 gives your salon a unique and personal touch.
An innovative design with high-quality materials and impressive tanning performance.

TOWER SPACE 2000



Lamps



Easy Control



Body Cool



Sound System



Mega Voice



VibraNano*

TECHNICAL DATA

Lamps:	50 x pureSunlight lamps (~ 74,80")	180 W
Power consumption:	10,2 kW	
Weight:	~1074 lbs	
Floor plate:	330 lbs (max. load capacity)	

ELECTRICAL REQUIREMENTS

Power connection:	rear side left
Protective class:	IP20
Mains voltage:	3-phase: 3 x 220 V / ~ / 60 Hz
Wire cross section:	3-phase: 4 x AWG8
Circuit breaker recommended:	3-phase: 3 x 40 A
	All tanning devices with Class-A ground fault circuit interrupter GFCI.

CENTRAL EXHAUST AIR DISCHARGE

Fan:	Exhaust-air socket ~11.81 inch
Minimum exhaust air flow rate:	528344 gal/hour
Exhaust-air hose:	Ø ~11.81 inch

DIMENSIONS

Recommended roomsize:	7' x 7'
Dimensions in inch (HxWxD):	~85.83" x ~55.12" x ~55.31" (closed)
	~85.83" x ~55.12" x ~77.28" (open)

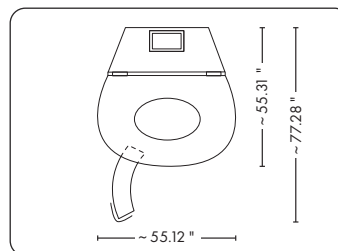
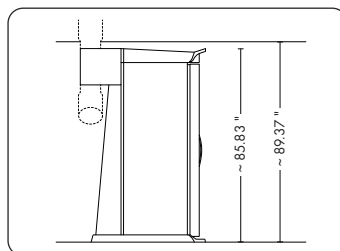

Contraindication: This product is contraindicated for use on persons under the age of 18 years. "Contraindication: This product must not be used if skin lesions or open wounds are present." "Warning: This product should not be used on individuals who have had skin cancer or have a family history of skin cancer." "Warning: Persons repeatedly exposed to UV radiation should be regularly evaluated for skin cancer." © Copyright 2022 KBL GmbH, Germany. Errors and omissions possible. KBL GmbH reserves the right to change technical data without notice.